

# BX01-002 欧标P6铝型材 30系列



## 欧标P6/30系列工业铝型材

1. 槽宽6.3mm欧标铝型材, 适用于中轻型设备的结构中;
2. 常用尺寸为30x30, 30x60, 60x60的铝型材;
3. 传统圆洞中心孔, 连接更牢固;
4. 重量和尺寸适中, 经典结构, 易于和配件连接.

材料: A6063-T5铝合金,  
表面阳极氧化;

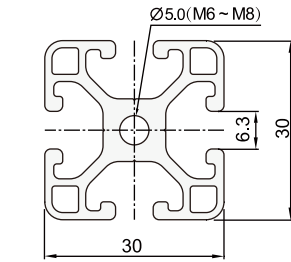
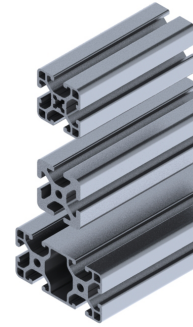

a

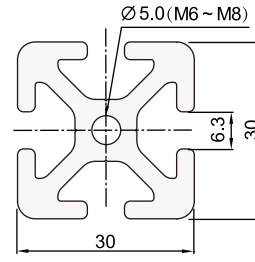

b

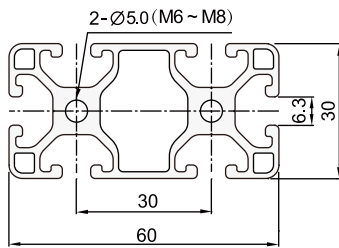

c

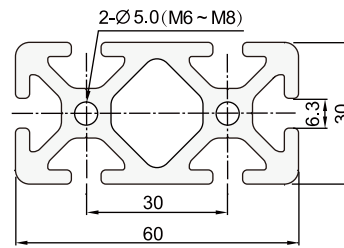

d

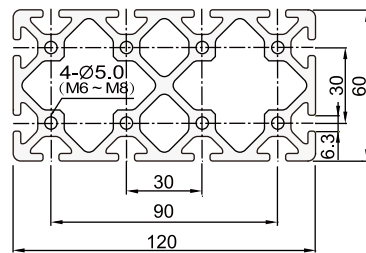

e

槽型	规格	长度/M	重量/KG/M	定货号
a	P6 P6 30x30S L	6.0 Max.	0.888	011.6001.03-L
b	P6 P6 30x30S H	6.0 Max.	1.251	011.6003.05-L
c	P6 P6 60x30S L	6.0 Max.	1.549	011.6002.03-L
d	P6 P6 60x30S H	6.0 Max.	2.265	011.6004.05-L
e	P6 P6 120x60S H	6.0 Max.	6.495	011.6005.05-L