

# 3-911 导槽 FS

用于扁杆，快速安装



用于扁杆的导槽。推入预焊螺钉即可快速安装

- 不需要使用任何工具安装
- 预焊螺柱为M6x16-20mm
- 导槽装在预焊螺钉上以滑动
- 听见咔哒声时说明已到末端

- 从顶部可检查安装情况
- 导槽已安装的情况下依然能安装或卸除扁杆
- 用螺丝刀松掉夹子即可把导槽松掉并且移走
- 防震

材料:

- 导槽: PA
- 分离力可定制

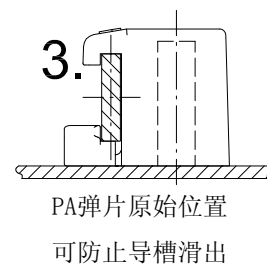
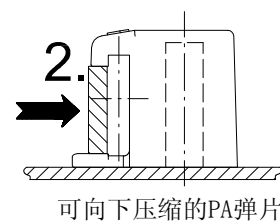
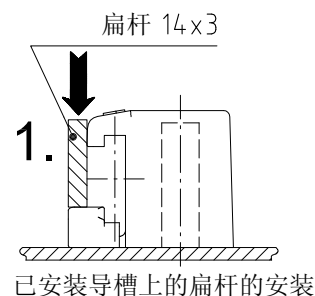
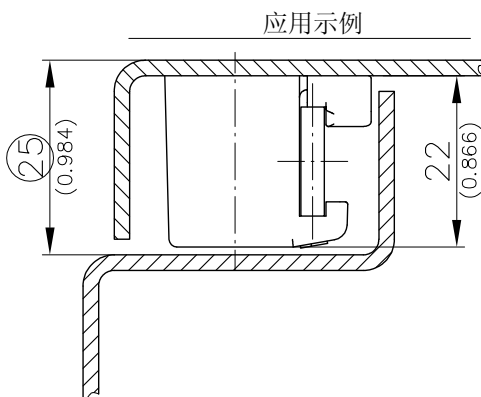
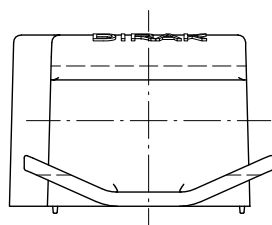
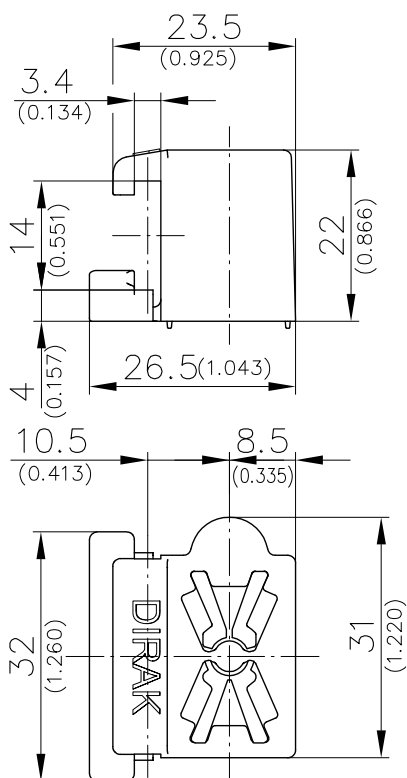

操作示例

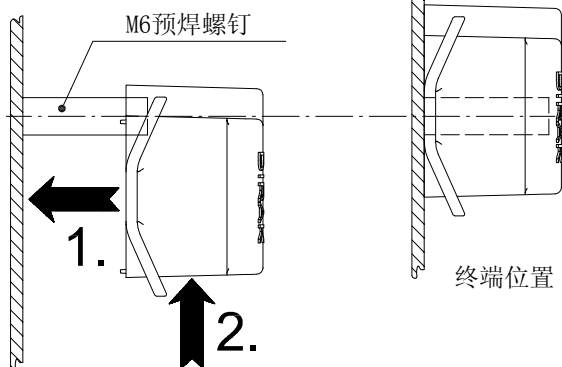

安装在预焊螺柱上

导槽 用于扁杆，可快速安装

定货号

208-1523.54-0000